

# Multistage Horizontal Centrifugal Pump

## Comeo

### Type Series Booklet



## **Legal information/Copyright**

Type Series Booklet Comeo

All rights reserved. The contents provided herein must neither be distributed, copied, reproduced, edited or processed for any other purpose, nor otherwise transmitted, published or made available to a third party without the manufacturer's express written consent.

Subject to technical modification without prior notice.

© KSB SE & Co. KGaA, Frankenthal 2023-03-14

## Contents

<b>Centrifugal Pumps</b> .....	<b>4</b>
Multistage Horizontal Centrifugal Pumps.....	4
Comeo.....	4
Main applications.....	4
Fluids handled .....	4
Operating data.....	4
Design details .....	4
Designation .....	5
Materials.....	6
Product benefits.....	6
Product information .....	6
Product information as per Regulation No. 1907/2006 (REACH) .....	6
Certifications .....	6
Selection information .....	6
Minimum flow rate and maximum flow rate.....	6
Overview of product features / selection tables .....	8
Shaft seal .....	8
Technical data .....	9
Comeo C, 1~ 230 V, 50 Hz.....	9
Comeo C, 1~230 V, 60 Hz.....	9
Comeo C, 230/400 V, 50 Hz.....	9
Comeo C, 230/400 V, 60 Hz.....	10
Comeo G, 1~ 230 V, 50 Hz .....	10
Comeo G, 1~230 V, 60 Hz .....	10
Comeo G, 230/400 V, 50 Hz .....	11
Comeo G, 230/400 V, 60 Hz .....	11
Characteristic curves.....	12
n ≈ 2900 rpm.....	12
Comeo; 2; n ≈ 2900 rpm.....	12
Comeo; 4; n ≈ 2900 rpm.....	13
Comeo; 6; n ≈ 2900 rpm.....	14
n ≈ 3500 rpm.....	15
Comeo; 2; n ≈ 3500 rpm.....	15
Comeo; 4; n ≈ 3500 rpm.....	16
Comeo; 6; n ≈ 3500 rpm.....	17
Dimensions and connections .....	18
Dimensions .....	18
Connections .....	19
General assembly drawing with list of components.....	20

## Centrifugal Pumps

### Multistage Horizontal Centrifugal Pumps

## Comeo



#### Installation

- Horizontal installation

#### Drive

- AC motor / three-phase asynchronous motor
- To IEC 60034-7
- Efficiency class IE3 to IEC 60034-30 (for three-phase motors  $\geq 0.75$  kW)
- Frequency 50 Hz/60 Hz
- 2 poles
- Thermal class F
- Enclosure IP55
- Duty type: continuous duty S1
- Temperature protection switch with automatic reset for single-phase AC motor

#### Shaft seal

- Mechanical seal
- To EN 12756
- Uncooled
- Maintenance-free

#### Main applications

- Cold water pressure booster system
- Cold water systems
- General irrigation systems
- Light industrial applications

#### Fluids handled

- Clean water (without solids)
- Slightly aggressive fluid

#### Operating data

Table 1: Operating properties

Characteristic		Value
Flow rate	Q [m <sup>3</sup> /h]	$\leq 10,8$
Head	H [m]	$\leq 79,5$
Fluid temperature	T [°C]	$\geq -10$
		$\leq +60$
Ambient temperature	T [°C]	$\geq -20$
		$\leq +40$ <sup>1)</sup>
Pressure class	PN [bar]	$\leq 10$

#### Design details

##### Design

- Multistage
- Close-coupled design
- Extended motor shaft
- Maximum pressure class PN 10

<sup>1</sup> Optional:  $\leq +55$  °C

## Designation

**Table 2:** Designation example

Position																															
1	2	3	4	5	6	7	8	9	10	11	12	13	14	15	16	17	18	19	20	21	22	23	24	25	26	27	28	29	30	31	32
C	o	m	e	o			C			I	0	0	4	/	0	6	-	A	4	B	3	2	F	S	0	9	0	E	5	M	W
See name plate and data sheet																See data sheet															

**Table 3:** Designation key

Position	Code	Description	
1-7	Pump type		
	Comeo	Comeo	
8-9	Design		
	C	Cast steel	1.4308 (casing)
		Stainless steel	1.4301 (hydraulic system)
	G	Grey cast iron	EN-GJL-250 (casing)
Stainless steel		1.4301 (hydraulic system)	
10	Connection type		
	I	Internal thread	
11-13	Size		
	002	2	
	...	...	
	006	6	
15-16	Number of stages		
	01	1	
	...	...	
	06	6	
17	Trimmed impellers		
	-	No trimmed impeller	
18	Product generation		
	A	Comeo from 2015	
19	Connection standard		
	4	Internal thread / EN ISO 228-1	
20	Material variant		
	A	Grey cast iron	EN-GJL-250 (casing)
		Stainless steel	1.4301 (hydraulic system)
	B	Cast steel	1.4308 (casing)
Stainless steel		1.4301 (hydraulic system)	
21-22	Seal code		
	31	BVPFF	
	32	BVEFF	
23	Mechanical seal design		
	F	Fixed design	
24	Drive		
	S	Standard IEC	
25-27	Motor size		
	071	IEC 071	
	080	IEC 080	
	090	IEC 090	
28	Pressure class		
	E	PN10	
29	Number of motor poles		
	5	50 Hz, 2-pole	
	6	60 Hz, 2-pole	
30	Motor specification		
	C	230/400 V - IE2	
	M	230 V, single-phase AC motor	
	O	0.37/0.55 [kW], without IE classification	
	U	230/400 V - IE3	
31	PumpMeter		

Position	Code	Description
31	W	Without PumpMeter
32	Design	
	.. <sup>2)</sup>	Standard
	X	Non-standard (BT3D, BT3)

### Materials

**Table 4:** Overview of materials depending on material variant

Part No.	Description	In contact with water	Comeo C	Comeo G
10-6	Pump shroud	X	1.4301	
101	Pump casing	X	1.4308	EN-GJL-250
108.01/.04/.05	Stage casing	X	1.4301	
160	Cover	X	1.4301	
-	Shaft	X	1.4541	
230	Impeller	X	1.4301	
341	Drive lantern	-	EN-GJL-250	
412	O-ring	X	EPDM	
433	Mechanical seal	X	BVEFF	BVPFF
525.01/.03/.05	Spacer sleeve	X	1.4305	
903.05	Vent plug	X	1.4301 / EPDM	PEHD / TPE
905	Tie bolt	-	1.4057	
920.02/.03	Nut	X	1.4301	
930.02	Safety device	X	1.4401	
932	Circlip	X	1.4571	
950	Spring	X	1.4401	

**Table 5:** Comparison of materials

EN	General description	EN material code	EN standard	ASTM
EN-GJL-250	Cast iron	GJL-250	EN 1561	A48 - 40 B
1.4057	Chrome nickel steel	X17CrNi 16-2--QT800	EN 10088-3	A276 - 431
1.4301	Chrome nickel steel	X5CrNi 18-10	EN 10088	A276 - 304
1.4305	Chrome nickel steel	X8CrNiS 18-9	EN 10088	A276 - 303
1.4308	Chrome nickel steel	GX5CrNi19-10	EN 10213-4	A351 - Grade CF8
1.4401	Chrome nickel molybdenum steel	X5CrNiMo 17-12-2	EN 10088	A276 - 316
1.4541	Chrome nickel steel	X6CrNiMoTi 18-10	EN 10088	A276 - 321
1.4571	Chrome nickel molybdenum steel	X6CrNiMoTi 17-12-2	EN 10088	A276 - 316Ti

### Product benefits

- Top quality pump thanks to advanced high-precision production technology and durable high-grade materials
- An energy-saving, state-of-the-art pump solution characterised by high efficiency levels, optimum flow passage, the use of high-efficiency motors, and precision engineering of all hydraulic components
- High energy efficiency as well as low investment and maintenance costs make for low life cycle costs.
- Very compact, space-saving design



### Product information

#### Product information as per Regulation No. 1907/2006 (REACH)

For information as per European chemicals regulation (EC) No. 1907/2006 (REACH) see <https://www.ksb.com/en-global/company/corporate-responsibility/reach>.

### Certifications

**Table 6:** Overview

Label	Effective in:	Comment
	France	Approved in accordance with the French drinking water regulation
	United Kingdom	Approved in accordance with the UK drinking water regulation

### Selection information

#### Minimum flow rate and maximum flow rate

A minimum flow rate must be ensured to protect the pump against overheating and to prevent gas pockets, cavitation, etc.

<sup>2)</sup> Blank

**Table 7:** Minimum flow rate and maximum flow rate Q [m<sup>3</sup>/h] at a fluid temperature ≤ 20 °C

Size	Q			
	50 Hz		60 Hz	
	min.	max.	min.	max.
	[m <sup>3</sup> /h]	[m <sup>3</sup> /h]	[m <sup>3</sup> /h]	[m <sup>3</sup> /h]
2	0,2	3,3	0,2	4,0
4	0,4	6,5	0,5	7,8
6	0,6	9,0	0,8	10,8

Overview of product features / selection tables

**Shaft seal**

**Table 8:** Mechanical seal material – Comeo C

Code to EN 12756	Description	Material	Code	Comment
B	Primary ring	Carbon graphite	Ca	Resin-impregnated
V	Mating ring	Aluminium oxide	Ce	Ceramics
E	Elastomer	EPDM	EPDM	Ethylene propylene rubber <sup>3)</sup>
F	Spring	Chrome nickel steel	CrNi steel	-
F	Other metal parts	Chrome nickel steel	CrNi steel	-

**Table 9:** Mechanical seal material – Comeo G

Code to EN 12756	Description	Material	Code	Comment
B	Primary ring	Carbon graphite	Ca	Resin-impregnated
V	Mating ring	Aluminium oxide	Ce	Ceramics
P	Elastomer	NBR	NBR	Nitrile butadiene rubber
F	Spring	Chrome nickel steel	CrNi steel	-
F	Other metal parts	Chrome nickel steel	CrNi steel	-

---

<sup>3</sup> To ACS / WRAS



**Technical data**
**Comeo C, 1~ 230 V, 50 Hz**
**Table 10: 50 Hz**

Size	n	P <sub>N</sub>	I <sub>A</sub> /I <sub>N</sub>	cos φ	U <sub>N</sub>	η	L <sub>p</sub>	Cable gland	Maximum frequency of starts	I <sub>N</sub>	Mat. No.	[kg]
					Tolerance					1~230 V		
	[rpm]	[kW]	[%]	[%]	[dB]	[h <sup>-1</sup> ]	[A]					
2/2	2750	0,37	3,70	0,92	+/-10	67,00	58,00	1 × M18 × 1,5	20	2,60	48229175	13,1
2/4	2750	0,37	3,70	0,92	+/-10	67,00	58,00	1 × M18 × 1,5	20	2,60	48229176	13,8
2/6	2760	0,55	3,90	0,92	+/-10	70,00	56,00	1 × M18 × 1,5	20	3,69	48229177	15,9
4/2	2750	0,37	3,70	0,92	+/-10	67,00	58,00	1 × M18 × 1,5	20	2,60	48229178	13,1
4/4	2760	0,55	3,90	0,92	+/-10	70,00	56,00	1 × M18 × 1,5	20	3,69	48229179	15,3
4/6	2790	1,10	4,30	0,95	+/-10	75,00	58,00	1 × M20 × 1,5	20	6,68	48229180	20
6/2	2750	0,37	3,70	0,92	+/-10	67,00	58,00	1 × M18 × 1,5	20	2,60	48239930	13,4
6/4	2790	1,10	4,30	0,95	+/-10	75,00	58,00	1 × M20 × 1,5	20	6,68	48239931	19,7
6/6	2800	1,50	4,80	0,95	+/-10	76,00	58,00	1 × M20 × 1,5	20	8,99	48239932	23,1

**Comeo C, 1~230 V, 60 Hz**
**Table 11: 60 Hz**

Size	n	P <sub>N</sub>	I <sub>A</sub> /I <sub>N</sub>	cos φ	U <sub>N</sub>	η	L <sub>p</sub>	Cable gland	Maximum frequency of starts	I <sub>N</sub>	Mat. No.	[kg]
					Tolerance					1~230 V		
	[rpm]	[kW]	[%]	[%]	[dB]	[h <sup>-1</sup> ]	[A]					
2/2	3450	0,37	4,50	0,95	+/-10	74,00	64,00	1 × M18 × 1,5	20	2,30	48239933	13,1
2/4	3420	0,55	3,80	0,96	+/-10	74,00	65,00	1 × M18 × 1,5	20	3,35	48239934	15,2
2/6	3420	0,75	4,30	0,97	+/-10	75,00	68,00	1 × M20 × 1,5	20	4,50	48239935	17,4
4/2	3420	0,55	3,80	0,96	+/-10	74,00	65,00	1 × M18 × 1,5	20	3,35	48239936	14,5
4/4	3400	1,10	4,80	0,96	+/-10	79,00	72,00	1 × M20 × 1,5	20	6,30	48239937	19,3
4/6	3420	1,50	4,70	0,95	+/-10	76,00	75,00	1 × M20 × 1,5	20	9,10	48239938	22,7
6/2	3420	0,75	4,30	0,97	+/-10	75,00	68,00	1 × M20 × 1,5	20	4,50	48239939	16,3
6/4	3420	1,50	4,70	0,95	+/-10	76,00	75,00	1 × M20 × 1,5	20	9,10	48239940	22,4
6/6	3420	2,20	4,50	0,95	+/-10	77,00	78,00	1 × M20 × 1,5	20	13,10	48239941	25,1

**Comeo C, 230/400 V, 50 Hz**
**Table 12: 50 Hz**

Size	n	P <sub>N</sub>	I <sub>A</sub> /I <sub>N</sub>	cos φ	U <sub>N</sub>	η	L <sub>p</sub>	Cable gland	Maximum frequency of starts	I <sub>N</sub>	Mat. No.	[kg]
					Tolerance					230/400 V		
	[rpm]	[kW]	[%]	[%]	[dB]	[h <sup>-1</sup> ]	[A]					
2/2	2750	0,37	5,50	0,78	+/-10	74,20	64,00	1 × M20 × 1,5	20	1,64/0,94	48019667	14,9
2/4	2750	0,37	5,50	0,78	+/-10	74,20	64,00	1 × M20 × 1,5	20	1,64/0,94	48019668	15,4
2/6	2790	0,55	5,20	0,75	+/-10	77,60	58,00	1 × M20 × 1,5	20	2,31/1,33	48019669	17,1
4/2	2750	0,37	5,50	0,78	+/-10	74,20	64,00	1 × M20 × 1,5	20	1,64/0,94	48020138	15
4/4	2790	0,55	5,20	0,75	+/-10	77,60	58,00	1 × M20 × 1,5	20	2,31/1,33	48019675	16,3
4/6	2855	1,10	7,00	0,80	+/-10	82,70	60,00	2 × M20 × 1,5	25	4,22/2,43	48256815	20
6/2	2750	0,37	5,50	0,78	+/-10	74,20	64,00	1 × M20 × 1,5	20	1,64/0,94	48019678	14,9
6/4	2855	1,10	7,00	0,80	+/-10	82,70	60,00	2 × M20 × 1,5	25	4,22/2,43	48256816	19,7
6/6	2900	1,50	7,70	0,88	+/-10	84,20	63,00	2 × M25 × 1,5	25	5,08/2,92	48256817	23,1

**Comeo C, 230/400 V, 60 Hz**
**Table 13: 60 Hz**

Size	n	P <sub>N</sub>	I <sub>A</sub> /I <sub>N</sub>	cos φ	U <sub>N</sub>	η	L <sub>p</sub>	Cable gland	Maximum frequency of starts	I <sub>N</sub>	Mat. No.	[kg]
	[rpm]	[kW]	Tolerance	[%]	230/400 V							
	[h <sup>-1</sup> ]	[A]										
2/2	3300	0,37	6,00	0,78	+20/-5	75,70	64,00	1 × M20 × 1,5	20	1,54/0,89	48019670	14,9
2/4	3345	0,55	4,40	0,75	+20/-5	77,60	58,00	1 × M20 × 1,5	20	2,29/1,32	48019671	16,2
2/6	3440	0,75	6,50	0,80	+20/-5	80,90	60,00	2 × M20 × 1,5	25	2,87/1,65	48256818	17,4
4/2	3345	0,55	4,40	0,75	+20/-5	77,60	58,00	1 × M20 × 1,5	20	2,29/1,32	48019676	15,7
4/4	3440	1,10	6,70	0,81	+20/-5	82,90	60,00	2 × M20 × 1,5	25	4,72/2,72	48256819	19,3
4/6	3500	1,50	6,70	0,89	+20/-5	84,4	66,00	2 × M25 × 1,5	25	5,01/2,88	48256820	22,7
6/2	3440	0,75	6,50	0,80	+20/-5	80,90	60,00	2 × M20 × 1,5	25	2,87/1,65	48256821	16,3
6/4	3500	1,50	6,70	0,89	+20/-5	84,4	66,00	2 × M25 × 1,5	25	5,01/2,88	48256822	22,4
6/6	3500	2,20	6,70	0,90	+20/-5	86,10	66,00	1 × M25 × 1,5	25	7,12/4,09	48256823	25,1

**Comeo G, 1~ 230 V, 50 Hz**
**Table 14: 50 Hz**

Size	n	P <sub>N</sub>	I <sub>A</sub> /I <sub>N</sub>	cos φ	U <sub>N</sub>	η	L <sub>p</sub>	Cable gland	Maximum frequency of starts	I <sub>N</sub>	Mat. No.	[kg]
	[rpm]	[kW]	Tolerance	[%]	1~230 V							
	[h <sup>-1</sup> ]	[A]										
2/2	2750	0,37	3,70	0,92	+/-10	67,00	58,00	1 × M18 × 1,5	20	2,60	48229157	13,1
2/4	2750	0,37	3,70	0,92	+/-10	67,00	58,00	1 × M18 × 1,5	20	2,60	48229158	13,8
2/6	2760	0,55	3,90	0,92	+/-10	70,00	56,00	1 × M18 × 1,5	20	3,69	48229159	15,9
4/2	2750	0,37	3,70	0,92	+/-10	67,00	58,00	1 × M18 × 1,5	20	2,60	48229160	13,1
4/4	2760	0,55	3,90	0,92	+/-10	70,00	56,00	1 × M18 × 1,5	20	3,69	48229161	15,3
4/6	2790	1,10	4,30	0,95	+/-10	75,00	58,00	1 × M20 × 1,5	20	6,68	48229162	20
6/2	2750	0,37	3,70	0,92	+/-10	67,00	58,00	1 × M18 × 1,5	20	2,60	48229163	13,4
6/4	2790	1,10	4,30	0,95	+/-10	75,00	58,00	1 × M20 × 1,5	20	6,68	48229164	19,7
6/6	2800	1,50	4,80	0,95	+/-10	76,00	58,00	1 × M20 × 1,5	20	8,99	48229165	23,1

**Comeo G, 1~230 V, 60 Hz**
**Table 15: 60 Hz**

Size	n	P <sub>N</sub>	I <sub>A</sub> /I <sub>N</sub>	cos φ	U <sub>N</sub>	η	L <sub>p</sub>	Cable gland	Maximum frequency of starts	I <sub>N</sub>	Mat. No.	[kg]
	[rpm]	[kW]	Tolerance	[%]	1~230 V							
	[h <sup>-1</sup> ]	[A]										
2/2	3450	0,37	4,50	0,95	+/-10	74,00	64,00	1 × M18 × 1,5	20	2,30	48229166	13,1
2/4	3420	0,55	3,80	0,96	+/-10	74,00	65,00	1 × M18 × 1,5	20	3,35	48229167	15,2
2/6	3420	0,75	4,30	0,97	+/-10	75,00	68,00	1 × M20 × 1,5	20	4,50	48229168	17,4
4/2	3420	0,55	3,80	0,96	+/-10	74,00	65,00	1 × M18 × 1,5	20	3,35	48229169	14,5
4/4	3400	1,10	4,80	0,96	+/-10	79,00	72,00	1 × M20 × 1,5	20	6,30	48229170	19,3
4/6	3420	1,50	4,70	0,95	+/-10	76,00	75,00	1 × M20 × 1,5	20	9,10	48229171	22,7
6/2	3420	0,75	4,30	0,97	+/-10	75,00	68,00	1 × M20 × 1,5	20	4,50	48229172	16,3
6/4	3420	1,50	4,70	0,95	+/-10	76,00	75,00	1 × M20 × 1,5	20	9,10	48229173	22,4
6/6	3420	2,20	4,50	0,95	+/-10	77,00	78,00	1 × M20 × 1,5	20	13,10	48229174	25,1

**Comeo G, 230/400 V, 50 Hz**
**Table 16: 50 Hz**

Size	n [rpm]	P <sub>N</sub> [kW]	I <sub>A</sub> /I <sub>N</sub>	cos φ	U <sub>N</sub>	η	L <sub>p</sub> [dB]	Cable gland	Maximum frequency of starts [h <sup>-1</sup> ]	I <sub>N</sub>	Mat. No.	[kg]
					Tolerance					230/400 V		
	[%]	[%]	[A]									
2/2	2750	0,37	5,50	0,78	+/-10	74,20	64,00	1 × M20 × 1,5	20	1,64/0,94	48019662	15,5
2/4	2750	0,37	5,50	0,78	+/-10	74,20	64,00	1 × M20 × 1,5	20	1,64/0,94	48019663	16
2/6	2790	0,55	5,20	0,75	+/-10	77,60	58,00	1 × M20 × 1,5	20	2,31/1,33	48019664	17,6
4/2	2750	0,37	5,50	0,78	+/-10	74,20	64,00	1 × M20 × 1,5	20	1,64/0,94	48019672	15,5
4/4	2790	0,55	5,20	0,75	+/-10	77,60	58,00	1 × M20 × 1,5	20	2,31/1,33	48019673	16,8
4/6	2855	1,10	7,00	0,80	+/-10	82,70	60,00	2 × M20 × 1,5	25	4,22/2,43	48256806	20
6/2	2750	0,37	5,50	0,78	+/-10	74,20	64,00	1 × M20 × 1,5	20	1,64/0,94	48019677	15,5
6/4	2855	1,10	7,00	0,80	+/-10	82,70	60,00	2 × M20 × 1,5	25	4,22/2,43	48256807	19,7
6/6	2900	1,50	7,70	0,88	+/-10	84,20	63,00	2 × M25 × 1,5	25	5,08/2,92	48256808	23,1

**Comeo G, 230/400 V, 60 Hz**
**Table 17: 60 Hz**

Size	n [rpm]	P <sub>N</sub> [kW]	I <sub>A</sub> /I <sub>N</sub>	cos φ	U <sub>N</sub>	η	L <sub>p</sub> [dB]	Cable gland	Maximum frequency of starts [h <sup>-1</sup> ]	I <sub>N</sub>	Mat. No.	[kg]
					Tolerance					230/400 V		
	[%]	[%]	[A]									
2/2	3300	0,37	6,00	0,78	+20/-5	75,70	67,00	1 × M20 × 1,5	20	1,54/0,89	48019665	15,5
2/4	3345	0,55	4,40	0,75	+20/-5	77,60	58,00	1 × M20 × 1,5	20	2,29/1,32	48019666	16,7
2/6	3440	0,75	6,50	0,80	+20/-5	80,90	60,00	2 × M20 × 1,5	25	2,87/1,65	48256809	17,4
4/2	3345	0,55	4,40	0,75	+20/-5	77,60	58,00	1 × M20 × 1,5	20	2,29/1,32	48019674	16,3
4/4	3440	1,10	6,70	0,81	+20/-5	82,90	60,00	2 × M20 × 1,5	25	4,72/2,72	48256810	19,3
4/6	3500	1,50	6,70	0,89	+20/-5	84,4	66,00	2 × M25 × 1,5	25	5,01/2,88	48256811	22,7
6/2	3440	0,75	6,50	0,80	+20/-5	80,90	60,00	2 × M20 × 1,5	25	2,87/1,65	48256812	16,3
6/4	3500	1,50	6,70	0,89	+20/-5	84,4	66,00	2 × M25 × 1,5	25	5,01/2,88	48256813	22,4
6/6	3500	2,20	6,70	0,90	+20/-5	86,10	66,00	1 × M25 × 1,5	25	7,12/4,09	48256814	25,1

Characteristic curves

$n \approx 2900$  rpm

Comeo; 2;  $n \approx 2900$  rpm

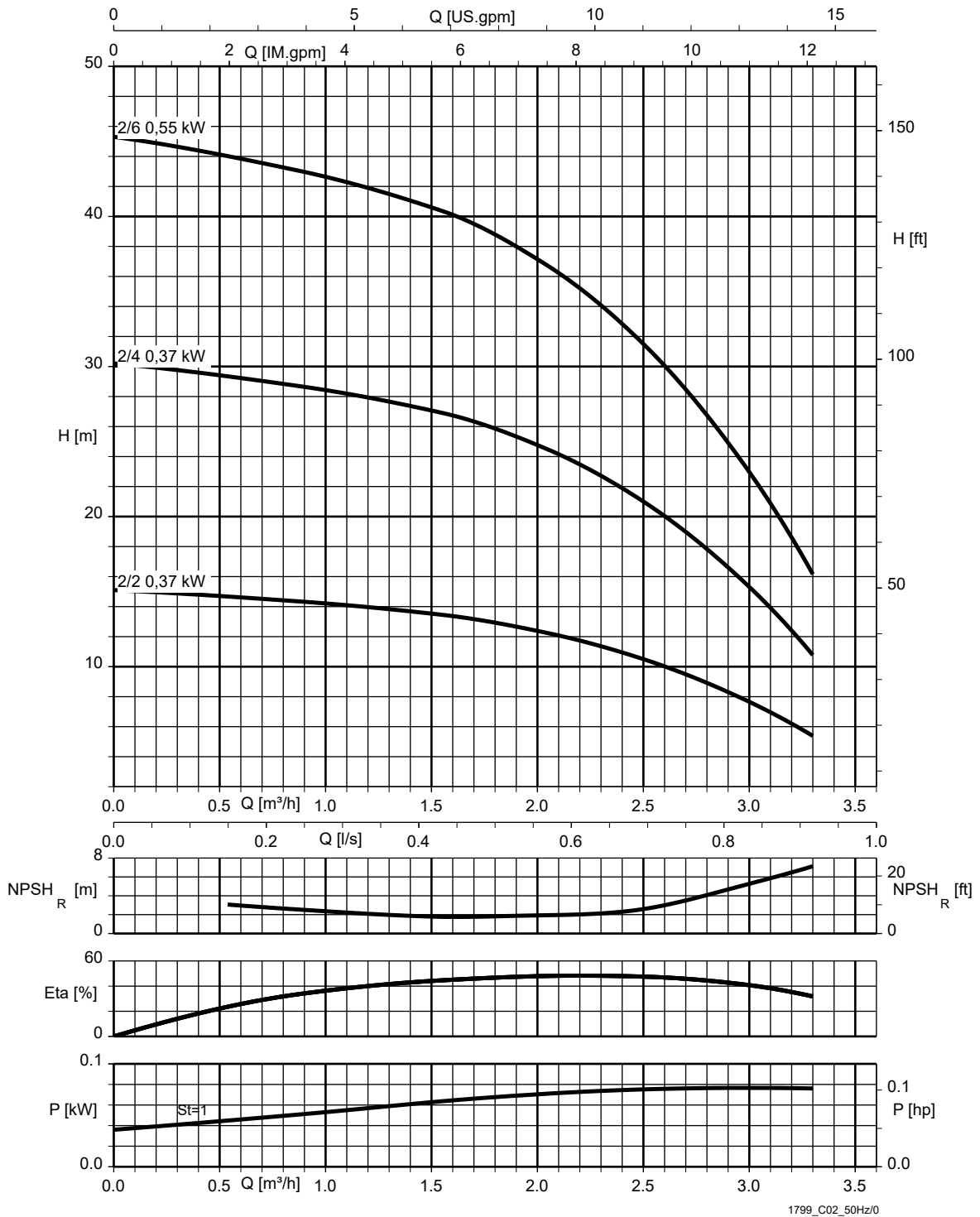

St = 1 | P per stage

Comeo; 4; n ≈ 2900 rpm

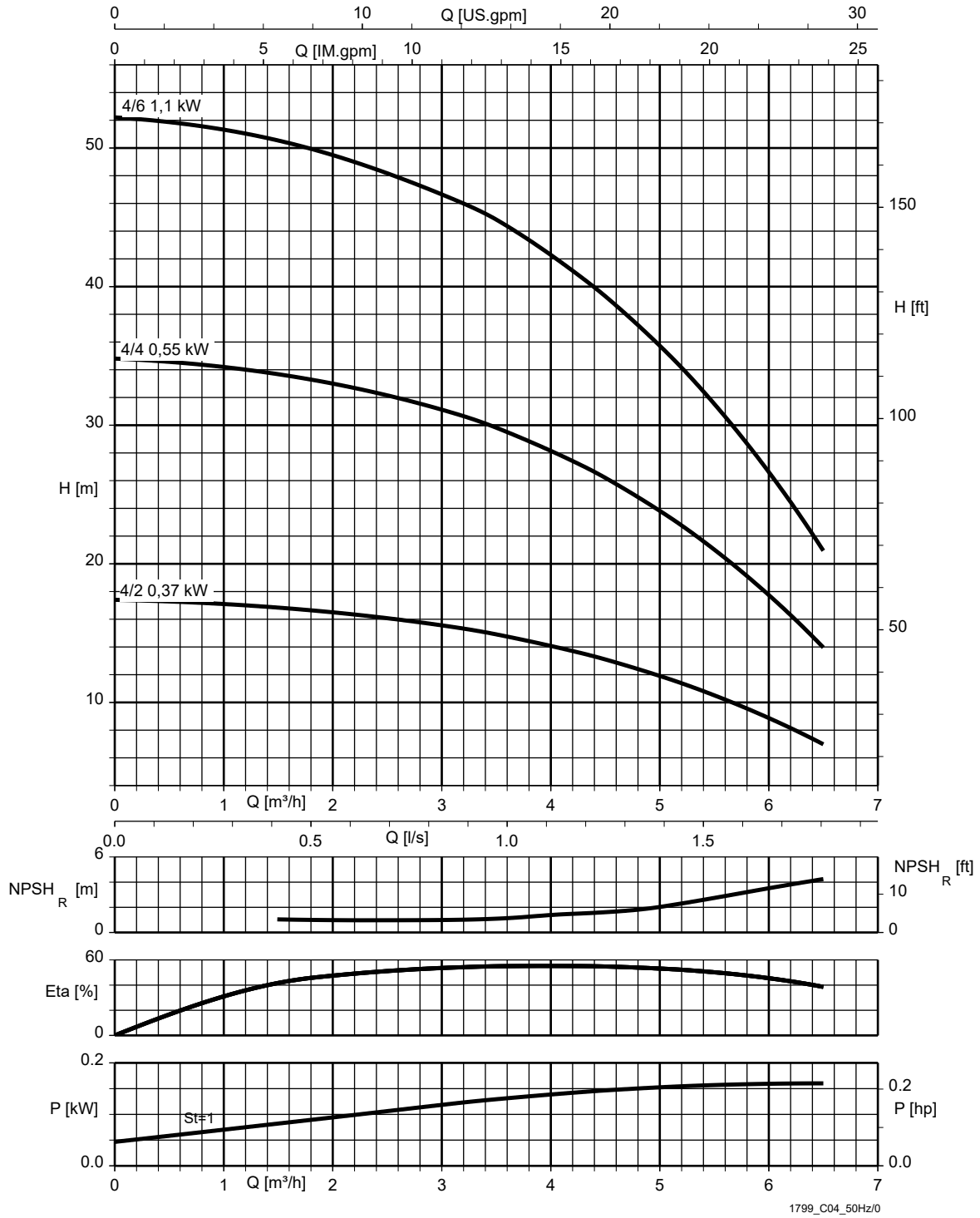

St = 1 | P per stage

Comeo; 6; n ≈ 2900 rpm

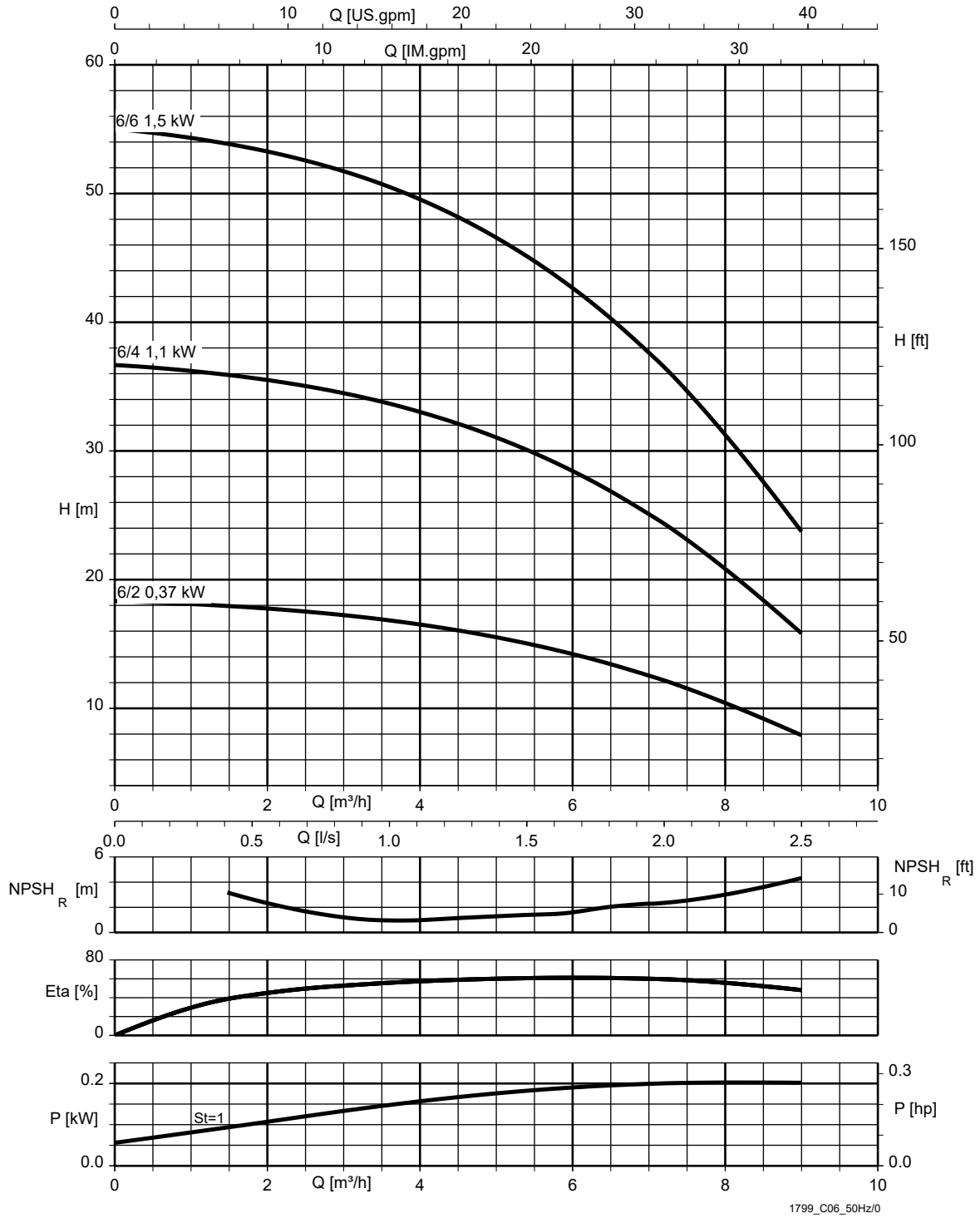

St = 1 | P per stage

1799.5/07-EN

$n \approx 3500$  rpm

Comeo; 2;  $n \approx 3500$  rpm

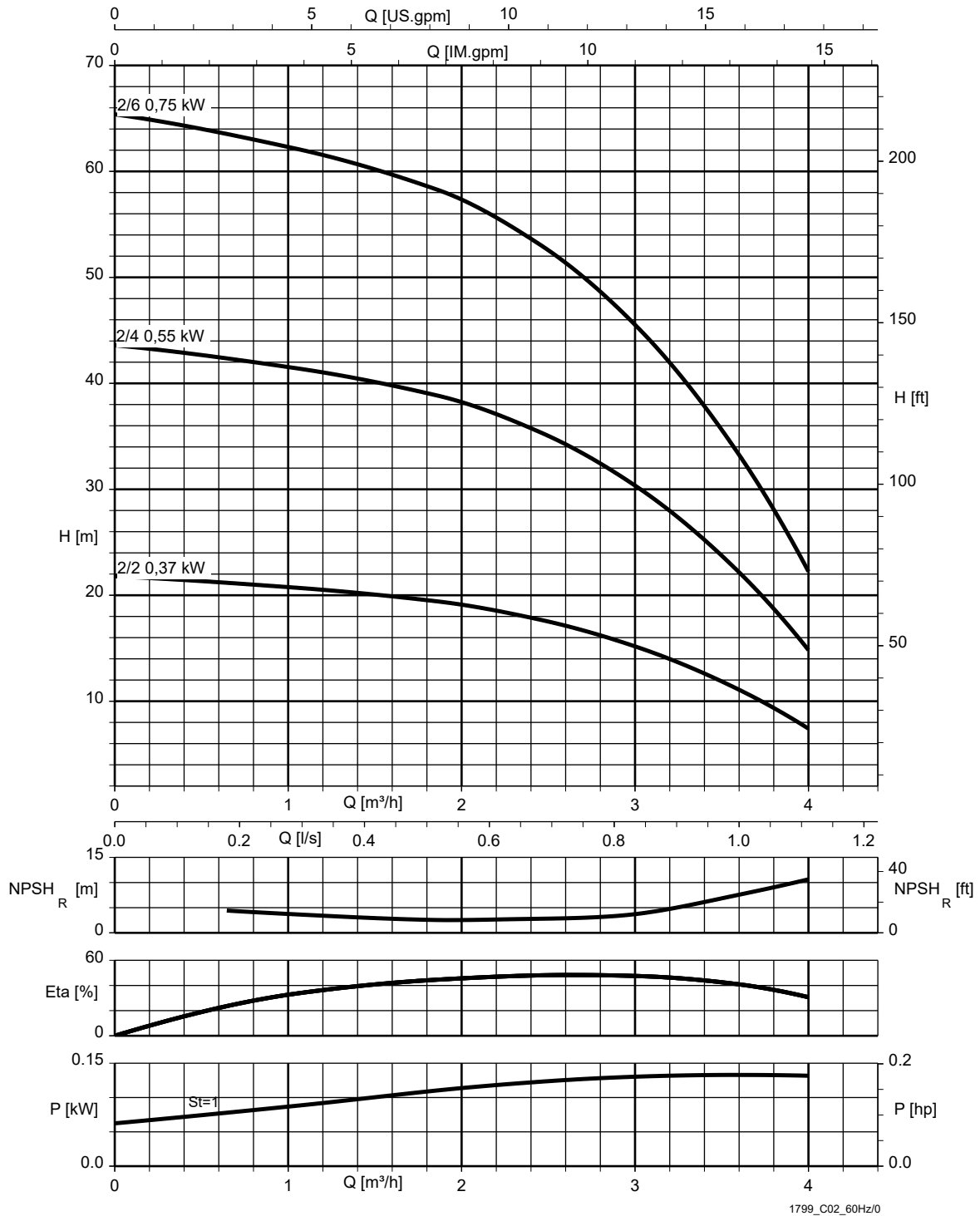

St = 1 | P per stage

1799.5/07-EN

Comeo; 4; n ≈ 3500 rpm

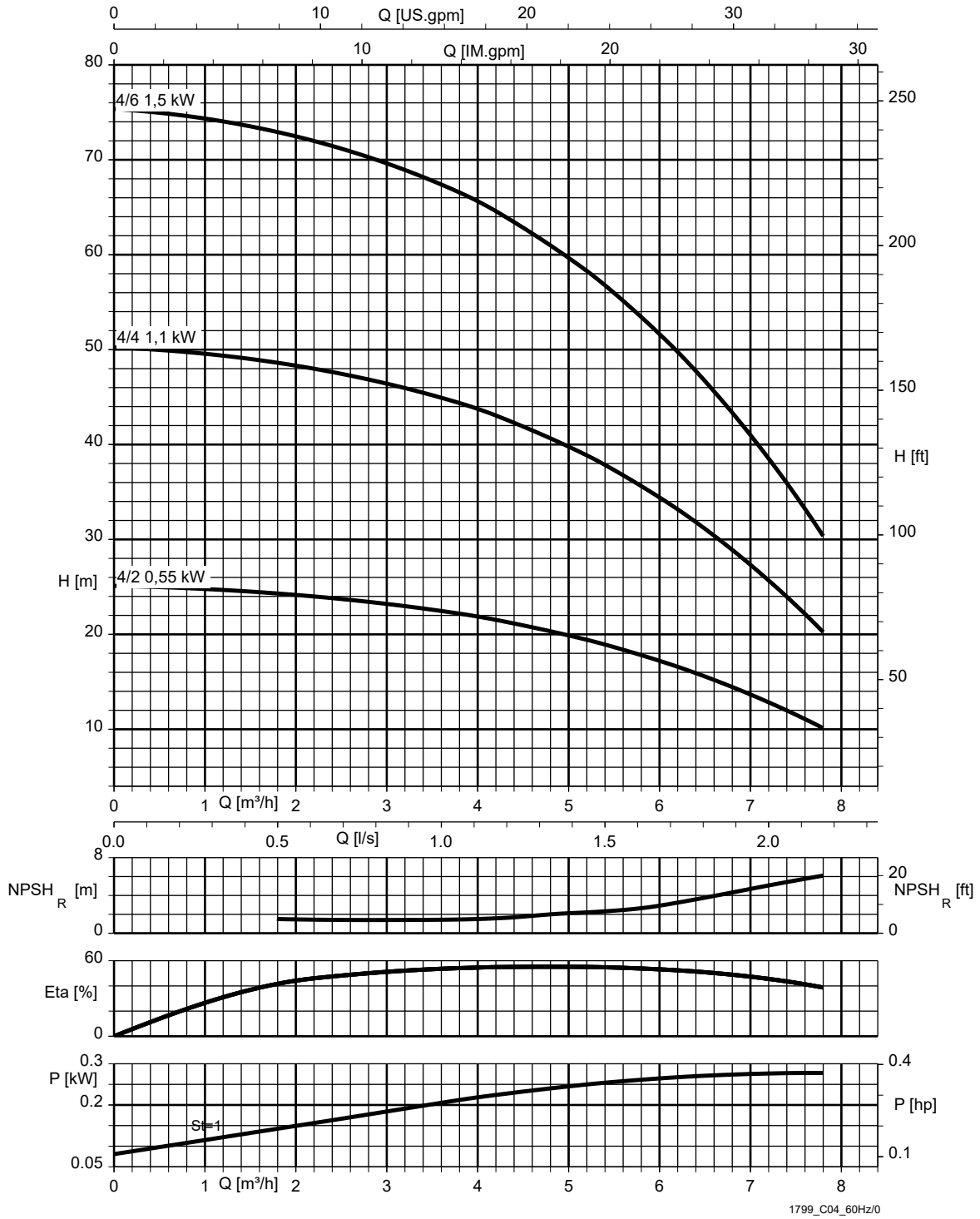

St = 1 | P per stage



Comeo; 6; n ≈ 3500 rpm

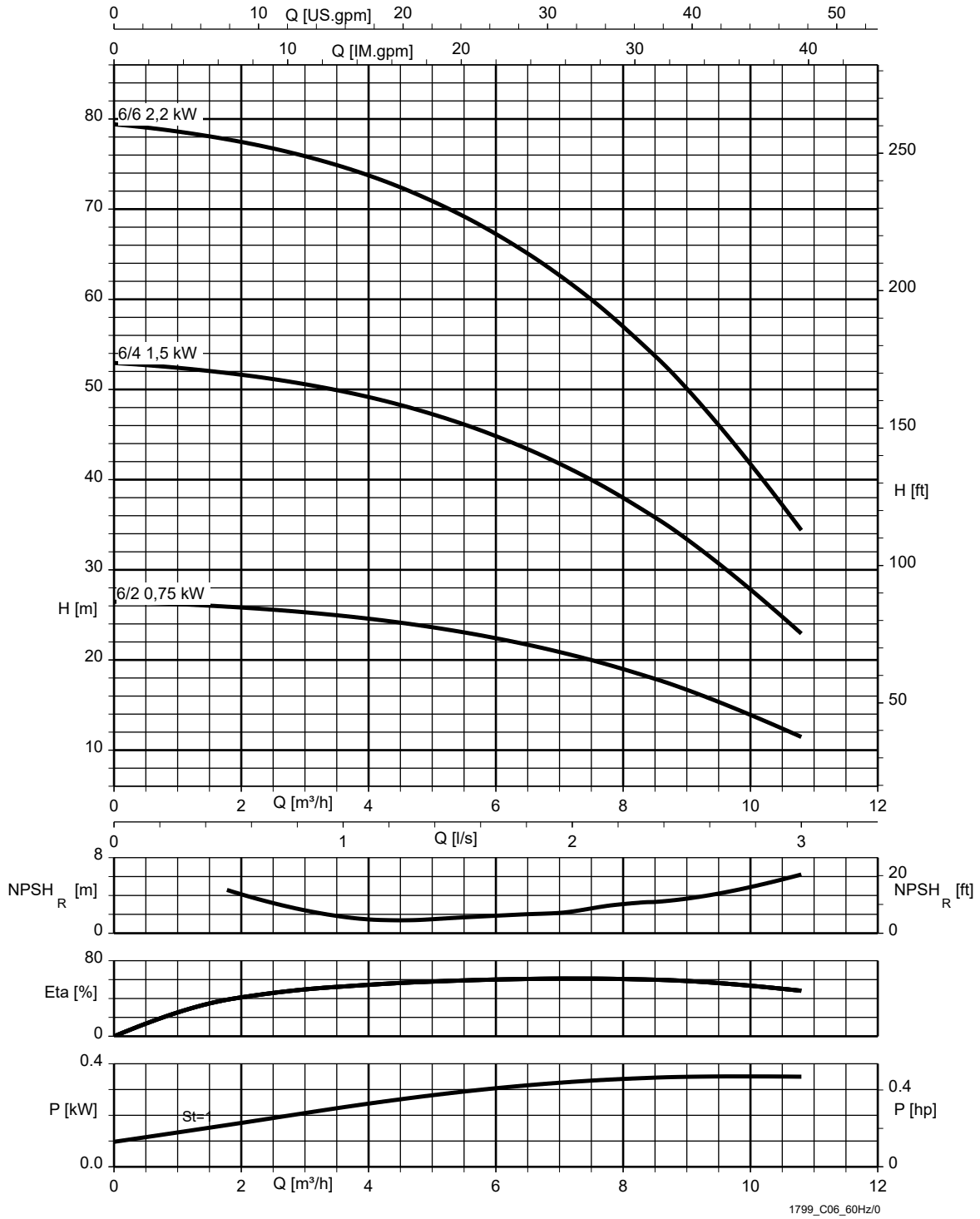

St = 1 | P per stage

## Dimensions and connections

### Dimensions

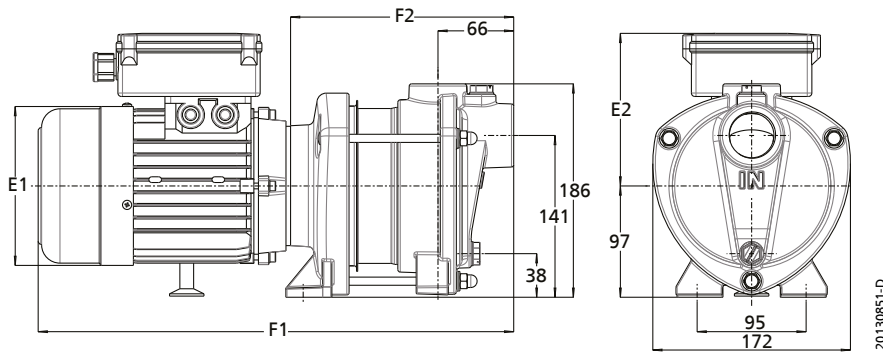

Fig. 1: Dimensions [mm]

Table 18: Dimensions, 1~230 V, 50 Hz

Size	P <sub>N</sub> [kW]	E1 [mm]	E2 [mm]	F1 [mm]	F2 [mm]
2/2	0,37	138,50	110,00	372,50	151,50
2/4	0,37	138,50	110,00	405,00	184,00
2/6	0,55	138,50	110,00	448,00	227,00
4/2	0,37	138,50	110,00	372,50	151,50
4/4	0,55	138,50	110,00	405,00	184,00
4/6	1,10	159,00	155,00	473,00	227,00
6/2	0,37	138,50	110,00	372,50	151,50
6/4	1,10	159,00	155,00	440,50	194,50
6/6	1,50	176,50	160,00	529,50	244,50

Table 19: Dimensions, 1~230 V, 60 Hz

Size	P <sub>N</sub> [kW]	E1 [mm]	E2 [mm]	F1 [mm]	F2 [mm]
2/2	0,37	138,50	110,00	372,50	151,50
2/4	0,55	138,50	110,00	405,00	184,00
2/6	0,75	159,00	155,00	473,00	227,00
4/2	0,55	138,50	110,00	372,50	151,50
4/4	1,10	159,00	155,00	430,00	184,00
4/6	1,50	176,50	160,00	512,00	227,00
6/2	0,75	159,00	155,00	397,50	151,50
6/4	1,50	176,50	160,00	479,50	194,50
6/6	2,20	176,50	160,00	529,50	244,50

Table 20: Dimensions, 230/400 V, 50 Hz

Size	P <sub>N</sub> [kW]	E1 [mm]	E2 [mm]	F1 [mm]	F2 [mm]
2/2	0,37	138,00	109,00	372,50	151,50
2/4	0,37	138,00	109,00	405,00	184,00
2/6	0,55	138,00	109,00	448,00	227,00
4/2	0,37	138,00	109,00	372,50	151,50
4/4	0,55	138,00	109,00	405,00	184,00
4/6	1,10	157,00	133,00	487,00	227,00
6/2	0,37	138,00	109,00	372,50	151,50
6/4	1,10	157,00	133,00	454,50	194,50
6/6	1,50	180,00	145,00	497,50	244,50

**Table 21: Dimensions, 230/400 V, 60 Hz**

Size	P <sub>N</sub> [kW]	E1 [mm]	E2 [mm]	F1 [mm]	F2 [mm]
2/2	0,37	138,00	109,00	372,50	151,50
2/4	0,55	138,00	109,00	405,00	184,00
2/6	0,75	157,00	133,00	484,00	227,00
4/2	0,55	138,00	109,00	372,50	151,50
4/4	1,10	157,00	133,00	444,00	184,00
4/6	1,50	180,00	145,00	480,00	227,00
6/2	0,75	157,00	133,00	408,50	151,50
6/4	1,50	180,00	145,00	447,50	194,50
6/6	2,20	180,00	145,00	529,50	244,50

**Connections**

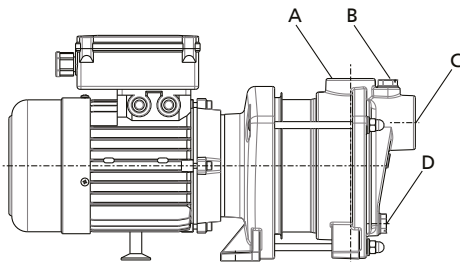

**Fig. 2: Connections**

A	Discharge nozzle (G 1), internal thread	C	Suction nozzle (G 1 1/4), internal thread
B	Screw filler plug (G 1/4)	D	Screw drain plug (G 1/4)

General assembly drawing with list of components

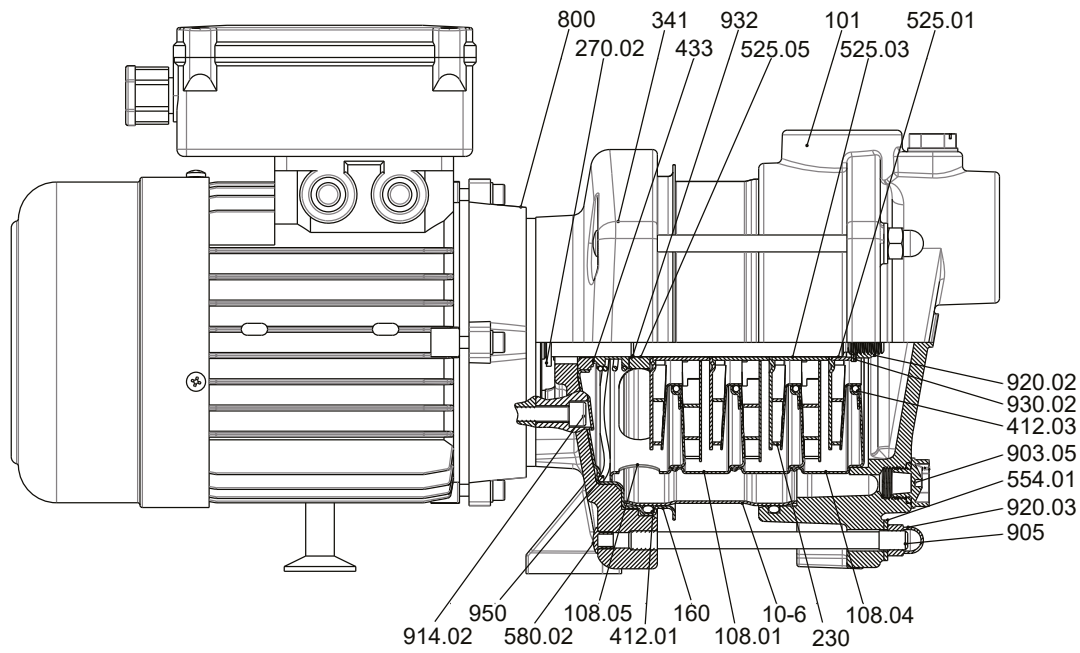

Fig. 3: General assembly drawing

Table 22: List of components

Part No.	Description	Part No.	Description
10-6	Pump shroud	554.01	Washer
101	Pump casing	580.02	Cap
108.01/.04/.05	Stage casing	800	Motor
160	Cover	903.05	Screw plug
230	Impeller	905	Tie bolt
270.02	Deflector	914.02	Hexagon socket head cap screw
341	Drive lantern	920.02/.03	Nut
412.01/.03	O-ring	930.02	Safety device
433	Mechanical seal	932	Circlip
525.01/.03/.05	Spacer sleeve	950	Spring





**KSB SE & Co. KGaA**  
Johann-Klein-Straße 9 • 67227 Frankenthal (Germany)  
Tel. +49 6233 86-0  
[www.ksb.com](http://www.ksb.com)